

NOTE: Special drives are available on request.

STYLE A DRIVE

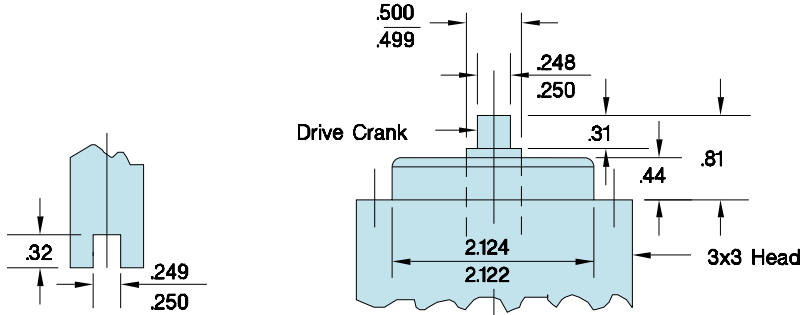

CAUTION: Driver must not bottom out against head drive crank

Style B, C, D and E Drives

Drive Style	Drill Head Size	D							
		HEAD SERIES							
		200	400	500	800				
B	5x10	5.55	—	—	—				
	6x8	140.97	—	—	—				
		5.62	7.12	—	—				
C DRIVE	8x12	6.50	8.00	—	—				
	8x16								
	10x15								
	10x20								
	12x18								
D DRIVE	12x24	165.10	203.20	—	—				
	14x14	7.75	9.25	9.94	—				
	14x21								
	14x28								
	16x16								
	16x24								
	16x32								
	18x18								
	18x27								
	18x36								
	20x20								
	E DRIVE					20x30	10.62	12.12	13.12
20x40									
24x24									
28x28									
24x36									
32x32									
28x44		269.74	307.84	333.24	368.30				
36x36									
32x60									
32x60		10.75	12.25	13.24	14.50				
		273.05	311.15	326.55	368.30				

STYLE B,C, and D Drives

Drive Style	Head Size	F	L	M	N	P	R	S	T	U
DRIVE B	4.50	3.50	1/4(.250)-20	.312	2.999	.281	.38	.906	.309	.312
	114.30	88.90		.315	2.997			.307		
	6.00	4.88	3/8(.375)-16	7.92	76.17	7.14	9.65	23.01	7.85	7.92
DRIVE C and D	8.00	5.50	3/8(.375)-16	.438	4.499	.406	.38	1.906	.434	.500
	203.20			.441	4.497				.431	
	152.40			123.95	8.00				76.12	
	and over	139.70		11.13	114.27	10.31	9.65	48.41	11.02	12.70
				11.20	114.22				10.95	

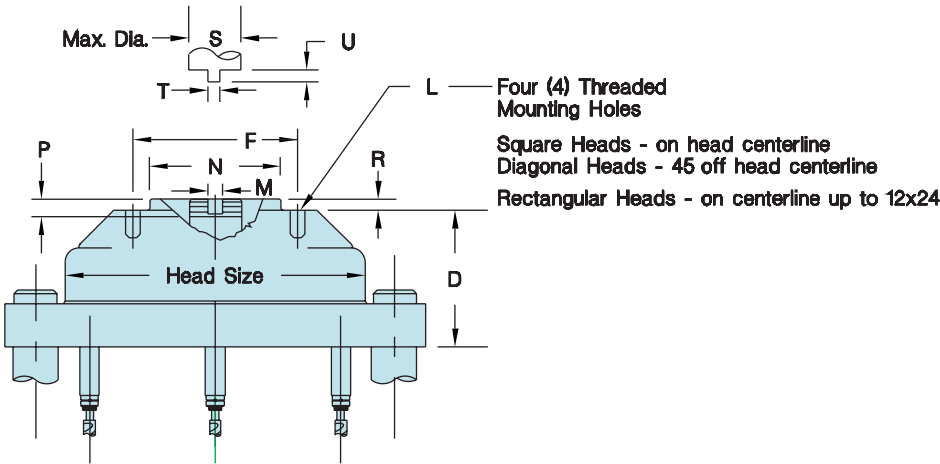

HEAVY DUTY MACHINE DRIVES

Style E Flange Mount

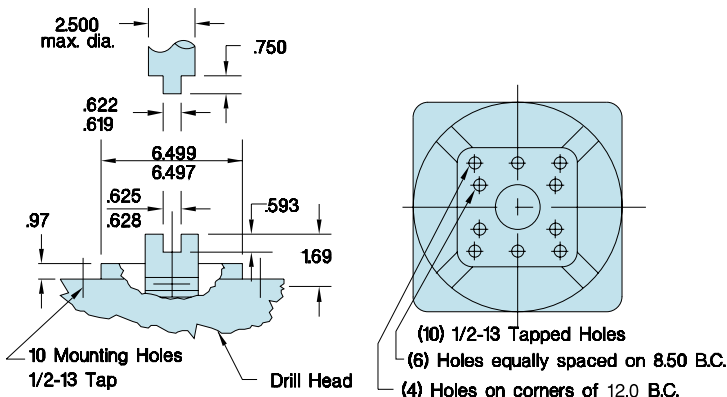

Style F Direct Motor Drive

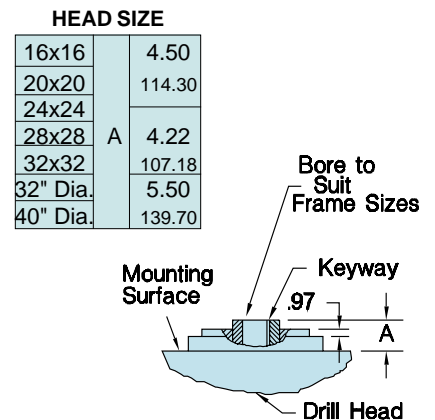

NOTE: Smaller numbers are metric conversions.

Drill Press & Quill Dia.	Taper	Driver No.	Driver Style	Quill Clamp No. & Head Mounting Bolt Circle		
				3.500 B.C.	4.875 B.C.	5.500 B.C.
Allen #2 2.750 Dia.	2 M.T.	708-1834	B	717-3120	717-4062	—
		708-1782	C&D	—	717-4112	—
Allen #2 & 35 2.750 Dia.	3 M.T.	708-1835	B	717-3364	717-4062	—
		708-1783	C&D	—	—	717-5343
Allen #2 2.750 Dia. With Power Feed	3 M.T.	708-1835	B	717-3364	717-4375	—
		708-1783	C&D	—	—	717-5375
Atlas 15" 1.812 Dia.	1 M.T.	708-1833	B	717-3109	—	—
		708-1834	B	717-3238	717-4241	—
Atlas 15" 1.812 Dia.	33 J.T.	708-3518	B	717-3152	717-4153	—
		708-3525	C&D	—	—	717-5175
Avey #2 3.500 Dia.	2 M.T.	708-1834	B	717-3467	717-4732	—
		708-1782	C&D	—	—	717-5078
Avey #2 3.500 Dia.	3 M.T.	708-1835	B	717-3467	717-4732	—
		708-1783	C&D	—	—	717-5078
Avey #3 BMA 4.250 Dia.	3 M.T.	708-1835	B	717-3100	717-4086	—
		708-1783	C&D	—	—	717-5090
Avey #3 BMA 4.250 Dia.	4 M.T.	708-1835 with 3 to 4 M.T. Sleeve	B	717-3468	717-4367	—
		708-1784	C&D	—	—	717-5102
Buffalo #15 1.750 Dia.	33 J.T.	708-3518	B	717-3150	717-4151	—
		708-3525	C&D	—	—	717-5243
Buffalo #16 1.875 Dia.	2 M.T.	708-1834	B	717-3205-6 with Sleeve	717-4206-4 with Sleeve	—
		708-1782	C&D	—	—	717-5207-4 with Sleeve
Buffalo #16 1.875 Dia.	3 M.T.	708-1835	B	717-3205-6 with sleeve	717-4206-4 with sleeve	—
		708-1783	C&D	—	—	717-5207-4 with Sleeve
Buffalo #18 2.375 Dia.	2 M.T.	708-1834	B	717-3205-2	717-4206-2	—
		708-1782	C&D	—	—	717-5207-2
Buffalo #18 2.375 Dia.	3 M.T.	708-1835	B	717-3205-2	717-4206-2	—
		708-1783	C&D	—	—	717-5207-2
Clausing 15" 1.988 Dia.	2 M.T.	708-1834	B	717-3191	717-4116	—
		708-1782	C&D	—	—	717-5311
Clausing 15" 1.988 Dia.	33 J.T.	708-3518	B	717-3197	717-4318	—
		708-3525	C&D	—	—	717-5197
Clausing 18" 2.365 Dia.	3 M.T.	708-1835	B	717-3178	717-4130	—
		708-1783	C&D	—	—	717-5067
Clausing 20" 2.488 Dia.	3 M.T.	708-1835	B	717-3082	717-4127	—
		708-1783	C&D	—	—	717-5196
Dumore #24, 26, & 28 1.750 Dia.	2 J.T.	708-3517	B	717-3150	717-4151	—
		708-3522	C&D	—	—	717-5243
Hypneumat Series 200 1.625 Dia.	2 J.T.	708-3517	B	717-3158	717-4159	—
		708-3522	C&D	—	—	717-5274
Hypneumat Series 300 & 350 1.750 Dia.	2 J.T.	708-3517	B	717-3160	717-4161	—
		708-3522	C&D	—	—	717-5162
Hypneumat Series 400 2.375 Dia.	2 M.T.	708-1834	B	717-3369	717-4355	—
		708-1782	C&D	—	—	717-5374
Hypneumat Series 400 2.375 Dia.	3 M.T.	708-1835	B	717-3192	717-4176	—
		708-1783	C&D	—	—	717-5277
Leland Gifford #2 LMS 2.875 Dia.	2 M.T.	708-1834	B	717-3347	717-4348	—
		708-1782	C&D	—	—	717-5349
Leland Gifford #2 LMS & 23 2.875 Dia.	3 M.T.	708-1835	B	717-3400	717-4088	—
		708-1783	C&D	—	—	717-5346
Powermatic 15" 2.186 Dia.	2 M.T.	708-1834	B	717-3179	717-4320	—
		708-1782	C&D	—	—	717-5256
Powermatic 15" 2.186 Dia.	33 J.T.	708-3518	B	717-3252	717-4388	—
		708-3525	C&D	—	—	717-5391
Powermatic 20" 2.750 Dia.	2 M.T.	708-1834	B	717-3364	717-4062-1	—
		708-1782	C&D	—	—	717-5420
Powermatic 20" 2.750 Dia.	3 M.T.	708-1835	B	717-3364	717-4062-1	—
		708-1783	C&D	—	—	717-5240
Rockwell Delta 14" 1.750 Dia.	1 M.T.	708-1833	B	717-3300	717-4995	—
		—	C&D	—	—	—
Rockwell Delta 14" 1.750 Dia.	2 M.T.	708-1834	B	717-3300	717-4995	—
		708-1782	C&D	—	—	—
Rockwell Delta 14" 1.750 Dia.	2 J.T.	708-3517	B	717-3150	717-4151	—
		708-3522	C&D	—	—	717-5243
Rockwell Delta 15" 2.000 Dia.	1 M.T.	708-1833	B	717-3185	717-4050	—
		—	C&D	—	—	—
Rockwell Delta 15" 2.000 Dia.	2 M.T.	708-1834	B	717-3185	717-4070	—
		708-1782	C&D	—	—	717-5317

Drill Press & Quill Dia.	Taper	Driver No.	Driver Style	Quill Clamp No. & Head Mounting Bolt Circle		
				3.500 B.C.	4.875 B.C.	5.500 B.C.
Rockwell Delta 15" 2.000 Dia.	33 J.T.	708-3518	B	717-3154	717-4155	—
		708-3525	C&D	—	—	717-5429
Rockwell Delta 17" 2.250 Dia.	2 M.T.	708-1834	B	717-3301	717-4998	—
		708-1782	C&D	—	—	717-5449
Rockwell Delta 17 2.250 Dia.	33 J.T.	708-3518	B	717-3156	717-4157	—
		708-3525	C&D	—	—	717-5157
Rockwell Delta 20" 2.375 Dia.	2 M.T.	708-1834	B	717-3205-1	717-4206-1	—
		708-1782	C&D	—	—	717-5207-1
Rockwell Delta 20" 2.375 Dia.	3 M.T.	708-1835	B	717-3205-1	717-4206-1	—
		708-1783	C&D	—	—	717-5207-1
Snow Drill Unit #1 3.000 Dia.	1 M.T.	708-1833	B	717-3432	717-4405	—
		—	C&D	—	—	—
Snow Drill Unit #2 3.437 Dia.	2 M.T.	708-1834	B	717-3434	717-4435	—
		708-1782	C&D	—	—	717-5436
Snow Drill Unit #3 3.750 Dia.	2 M.T.	708-1834	B	717-3437	717-4438	—
		708-1782	C&D	—	—	717-5439
Sugino ESB-6020 & ESBW-6020 1.968 Dia.	1 J.T.	708-3516	B	717-3472	717-4463	—
		708-3521	C&D	—	—	—
Sugino ESB-6030 ESBW-6030 1.968 Dia.	1 J.T.	708-3516	B	717-3472	717-4463	—
		708-3521	C&D	—	—	—
Sugino ESB-W1308-U 1.968 Dia.	33 J.T.	708-3518	B	717-3473	—	—
		708-3525	C&D	—	—	—
Sugino ESBPW1318-U 1.968 Dia.	33 J.T.	708-3518	B	717-3474	717-4460	—
		708-3525	C&D	—	—	717-5901
Sugino ESC-W1323-U 2.952 Dia.	33 J.T.	708-3518	B	717-3475	717-4461	—
		708-3525	C&D	—	—	—
Sugino ESB-W1305U 3.739 Dia.	33 J.T.	708-3518	B	717-3476	717-4462	—
		708-3525	C&D	—	—	717-5903
Sugino ESD-W1315U 3.739 Dia.	33 J.T.	708-3518	B	717-3476	717-4462	—
		708-3525	C&D	—	—	717-5903
Sugino ESD-W2403 3.739 Dia.	2 M.T.	708-1834	B	717-3477	—	—
		708-1782	C&D	—	—	—
Sugino STB-108U 1.968 Dia.	33 J.T.	708-3518	B	717-3473	717-4459	—
		708-3525	C&D	—	—	717-5900
Walker-Turner 15" 2.000 Dia.	2 M.T.	708-1834	B	717-3185	717-4070	—
		708-1782	C&D	—	—	717-5317
Walker-Turner 15" 1.812 Dia.	33 J.T.	708-3518	B	717-3152	717-4153	—
		708-3525	C&D	—	—	717-5175
Walker-Turner 17" 2.250 Dia.	2 M.T.	708-1834	B	717-3301	717-4998	—
		708-1782	C&D	—	—	717-5449
Walker-Turner 20" 2.375 Dia.	2 M.T.	708-1834	B	717-3428	717-4187	—
		708-1782	C&D	—	—	717-5113
Walker-Turner 20" 2.375 Dia.	3 M.T.	708-1835	B	717-3428	717-4187	—
		708-1783	C&D	—	—	717-5207-1
Universal Automatic A-30 600 & A-30 601 2.250 Dia.	—	708-3519	B	717-3254	717-4255	—
		708-3520	C&D	—	—	717-5412
Universal Automatic Model "A" 2.250 Dia.	—	708-3519	B	717-3254	717-4255	—
		708-3520	C&D	—	—	717-5412
Zagar Thruster-250 1.875 Dia.	33 J.T.	708-3518	B	717-3050	717-4050	—
		708-3525	C-D	—	—	717-5050
Zagar Thruster-500 2.000 Dia.	33 J.T.	708-3518	B	717-3051	717-4051	—
		708-3525	C-D	—	—	717-5051
Zagar Thruster-1000 3.000 Dia.	3 J.T.	—	B	—	—	717-4052
		708-3523	C-D	—	—	717-5052

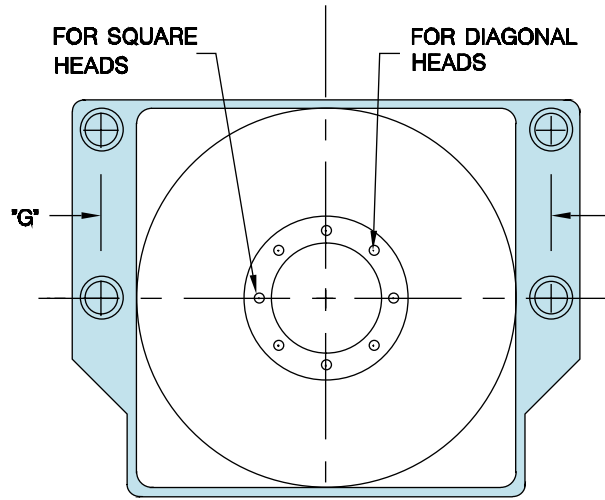

MAY REQUIRE ALTERATION OF OF MOUNTING FLANGE .200 TYP. ALL PLATES

Rear support plate assemblies are recommended for increased stability and linear tracking of complete drill or tap head fixture assemblies. Rear support assemblies contain guide rod bushings at standard guide rod positions. The plates are made from standard bushing plate castings, see Page 28 for dimensions.

HEAD SIZE	ORDER NO.	DESCRIPTION
3.00 76.20	-3820-2	Guide rod standard rear position
	-3820-3	Guide rod on horizontal centerline
	-3820-4	Guide rod and mounting for diagonal heads
4.50 114.30	-3821-2	Guide rod standard rear position
	-3821-3	Guide rod on horizontal centerline
	-3821-4	Guide rod and mounting for diagonal heads
6.00 152.40	-3822-2	Guide rod for standard rear position
	-3822-3	Guide rod on horizontal centerline
	-3822-4	Guide rod and mounting for diagonal heads
8.00 203.20	-3823-2	Guide rod for standard rear position
	-3823-3	Guide rod on horizontal centerline
	-3823-4	Guide rod and mounting for diagonal heads
10.00 254.00	-3824-2	Guide rod standard rear position
	-3824-3	Guide rod on horizontal centerline
	-3824-4	Guide rod and mounting for diagonal heads
12.00 304.80	-3825-2	Guide rod standard rear position
	-3825-3	Guide rod on horizontal centerline
	-3825-4	Guide rod and mounting for diagonal heads
16.00 406.40	-3826-2	Guide rod standard rear position
	-3826-3	Guide rod on horizontal centerline
	-3826-4	Guide rod and mounting for diagonal heads

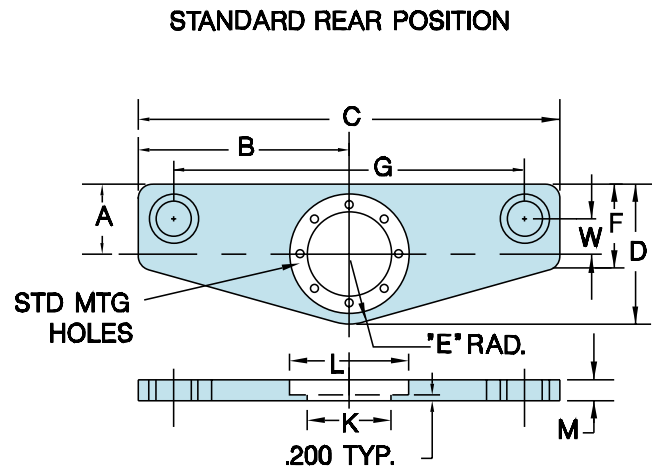
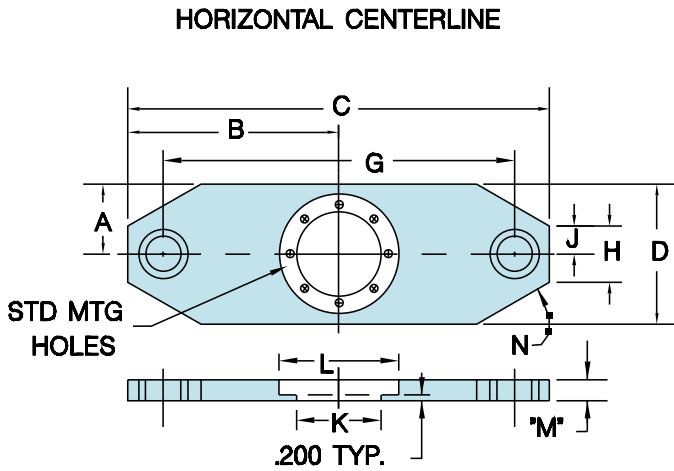

DRIVE STYLE	HEAD SIZE	735-	A	B	C	D	E	F	G	H	J	K	L	M	N	W
B	5.00 x 10.00	-0701-0510-2	2.50	7.50	15.00	5.00	1.75	3.00	6.500	—	—	3.000	4.25	.750	—	1.250
		-0701-0510-3	2.50	7.50	15.00	5.00	—	—	6.500	2.00	1.00	3.000	4.25	.750	30°	—
C	8.00 x 12.00	-0702-0812-2	4.12	8.50	17.00	7.88	3.75	3.00	14.500	—	—	4.500	6.75	.750	—	2.875
		-0702-0812-3	3.75	8.50	17.00	7.50	—	—	14.500	4.00	2.00	4.500	6.75	.750	30°	—
	8.00 x 16.00	-0702-0816-2	4.12	10.50	21.00	8.88	3.75	3.00	18.500	—	—	4.500	6.75	.750	—	2.875
		-0702-0816-3	4.75	10.50	21.00	7.50	—	—	18.500	4.00	2.00	4.500	6.75	.750	30°	—
	10.00 x 15.00	-0702-1015-2	5.12	10.00	20.00	8.88	3.75	3.00	17.500	—	—	4.500	6.75	.750	—	3.875
		-0702-1015-3	3.75	10.00	20.00	7.50	—	—	17.500	4.00	2.00	4.500	6.75	.750	30°	—
	10.00 x 20.00	-0702-1020-2	5.12	12.50	25.00	9.75	3.75	3.25	22.500	—	—	4.500	6.75	.750	—	3.875
		-0702-1020-3	3.75	12.50	25.00	8.00	—	—	22.500	4.00	2.00	4.500	6.75	.750	30°	—
	12.00 x 18.00	-0702-1218-2	6.00	11.50	23.00	9.75	3.75	3.25	20.500	—	—	4.500	6.75	.750	—	4.750
		-0702-1218-3	4.00	11.50	23.00	8.00	—	—	20.500	4.00	2.00	4.500	6.75	.750	30°	—
12.00 x 24.00	-0702-1224-2	6.00	14.50	29.00	9.75	3.75	3.50	26.500	—	—	4.500	6.75	.750	—	4.750	
	-0702-1224-3	4.00	14.50	29.00	8.00	—	—	26.500	4.00	2.00	4.500	6.75	.750	30°	—	
D	16.00 x 16.00	-0703-1616-2	8.50	11.00	22.00	14.50	6.00	6.00	19.000	—	—	4.500	10.50	1.000	—	6.750
		-0703-1616-3	6.00	11.00	22.00	12.00	—	—	19.000	4.00	2.00	4.500	10.50	1.000	45°	—
	16.00 x 24.00	-0703-1624-2	8.50	15.00	30.00	14.50	6.00	6.00	27.000	—	—	4.500	10.50	1.000	—	6.750
		-0703-1624-3	6.50	15.00	30.00	13.00	—	—	27.000	4.00	2.00	4.500	10.50	1.000	45°	—
	16.00 x 32.00	-0703-1632-2	8.50	19.00	38.00	14.50	6.00	6.00	35.000	—	—	4.500	10.50	1.000	—	6.750
		-0703-1632-3	6.50	19.00	38.00	13.00	—	—	35.000	4.00	2.00	4.500	10.50	1.000	45°	—
	20.00 x 20.00	-0703-2020-2	10.50	13.00	26.00	16.50	6.00	6.00	23.000	—	—	6.500	10.50	1.000	—	8.750
		-0703-2020-3	6.00	13.00	26.00	12.00	—	—	23.000	4.00	2.00	6.500	10.50	1.000	45°	—
	16.00 x 16.00	-0704-1616-2	8.50	11.00	22.00	14.50	6.00	6.00	19.000	—	—	6.500	10.50	1.000	—	6.750
		-0704-1616-3	6.00	11.00	22.00	12.00	—	—	19.000	4.00	2.00	6.500	10.50	1.000	45°	—
E	16.00 x 24.00	-0704-1624-2	8.50	15.00	30.00	14.50	6.00	6.00	27.000	—	—	6.500	10.50	1.000	—	6.750
		-0704-1624-3	6.50	15.00	30.00	13.00	—	—	27.000	4.00	2.00	6.500	10.50	1.000	45°	—
	16.00 x 32.00	-0704-1632-2	8.50	19.00	38.00	14.50	6.00	6.00	35.000	—	—	6.500	10.50	1.000	—	6.750
		-0704-1632-3	6.50	19.00	38.00	13.00	—	—	35.000	4.00	2.00	6.500	10.50	1.000	45°	—
	20.00 x 20.00	-0704-2020-2	10.50	13.00	26.00	16.50	6.00	6.00	23.000	—	—	6.500	10.50	1.000	—	8.750
		-0704-2020-3	6.00	13.00	26.00	12.00	—	—	23.000	4.00	2.00	6.500	10.50	1.000	45°	—
	20.00 x 30.00	-0704-2030-2	10.50	18.00	36.00	16.50	6.00	6.00	33.000	—	—	6.500	10.50	1.000	—	8.750
		-0704-2030-3	6.50	18.00	36.00	13.00	—	—	33.000	4.00	2.00	6.500	10.50	1.000	45°	—
	20.00 x 40.00	-0704-2040-2	10.50	23.00	46.00	16.50	6.00	6.00	43.000	—	—	6.500	10.50	1.000	—	8.750
		-0704-2040-3	6.50	23.00	46.00	13.00	—	—	43.000	4.00	2.00	6.500	10.50	1.000	45°	—
	24.00 x 24.00	-0704-2424-2	12.38	15.12	30.25	18.38	6.00	9.00	27.000	—	—	6.500	10.50	1.000	—	10.625
		-0704-2424-3	6.50	15.12	30.25	13.00	—	—	27.000	4.00	2.00	6.500	10.50	1.000	45°	—
	24.00 x 36.00	-0704-2436-2	12.38	21.12	42.25	18.38	6.00	9.00	39.000	—	—	6.500	10.50	1.000	—	10.625
		-0704-2436-3	6.50	21.12	42.25	13.00	—	—	39.000	4.00	2.00	6.500	10.50	1.000	45°	—
	28.00 x 28.00	-0705-2828-2	14.38	17.12	34.25	22.62	8.25	11.00	31.000	—	—	6.500	13.50	1.000	—	12.625
		-0705-2828-3	8.00	17.12	34.25	16.00	—	—	31.000	5.00	2.50	6.500	13.50	1.000	45°	—
28.00 x 44.00	-0705-2844-2	14.38	25.12	50.25	22.62	8.25	—	47.000	—	—	6.500	13.50	1.000	—	12.625	
	-0705-2844-3	8.00	25.12	50.25	16.00	—	—	47.000	5.00	2.50	6.500	13.50	1.000	45°	—	
36.00 x 36.00	-0705-3636-2	18.38	21.12	42.25	26.62	8.25	—	39.000	—	—	6.500	13.50	1.000	—	16.625	
	-0705-3636-3	8.00	21.12	42.25	16.00	—	—	39.000	5.00	2.50	6.500	13.50	1.000	45°	—	

NOTE: Smaller numbers are metric conversions.